



Quick Installation Guide

info@vrindappliances.in

www.vrindappliances.in

User Manual

1. Introduction

The purpose of this manual is to provide comprehensive instructions for safely and effectively using and maintaining your home appliance. By following these guidelines, you can ensure optimal performance and longevity, enhancing user satisfaction and minimizing the risk of damage or injury.

A **Wireless Automatic Water Level Controller** is an electronic system that monitors the level of water in a storage tank. It automatically switches the motor on when the tank is low and turns it off once it's full. This automation saves water, reduces energy consumption, and protects your motor from damage caused by dry runs.

Modern systems are equipped with intelligent sensors that detect water levels and send signals to the control unit. The controller then manages the motor operation accordingly, making it a reliable and user-friendly solution for every home.

2. Setup Guidelines

2.1 Unboxing

- Carefully remove the appliance from its packaging.
- Check for any visible damage or missing parts.
- Refer to the included parts list to ensure all components are accounted for.

2.2 Installation

Upper tank Sensor module Installation.

- Step 1
Connect the extension pipe to the water inlet pipe of the tank. Length 50 Cm.
Refer Image.



- Step 2

Find a suitable flat surface opposite to the water inlet pipe. Place the sensor module and follow the below steps.

1.



Image showing their should be gap between Tank lid and module casing.

2.



Image showing , mark the outer line of the Module casing with marker.

3.



Place the installation sticker at the center of the marking.

4.



Make 04 no's holes using drill tool as shown in the picture. 02 no's 16 mm holes and 02 no's 4 mm holes as per the marking of the sticker.

5.

Place the Sensor module with matching to the outlined marked previously and bolt the screws as shown in the picture below.

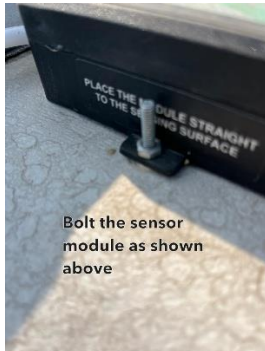

6. Arrange for a 230VAC 6A power socket nearby to the tank setup in rain protected area.

7. Connect positive (+) of the sensor module with (+) of the power adaptor and Negative (-) of the sensor module to the (-) of the adaptor. If required, use extension cable between Sensor module to the power adaptor. (Please take care of the polarity and proper connection).

8. Place the power adaptor in power socket as shown in the photo.



9. Connect the antenna in the to the sensor module gently, do not over tight.

Lower Tank Motor Module Installation.

- **Step 1**

Find a suitable place in open area and nearby to power plug(install if require) to install the motor module.

1. Please the Motor module against the wall and mark the 04 nos holes available the module as shown in photo.



2. Drill all the 04 no's holes with 6mm drill as shown in the photo.

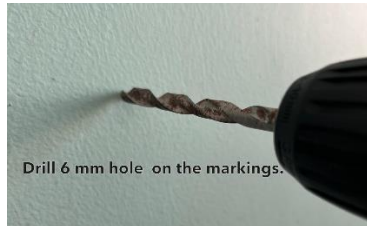

3. Put Plastic dowels in the holes .
4. Fix the Motor module with the help of screw with gentle tight using screw drives as shown in the photo.

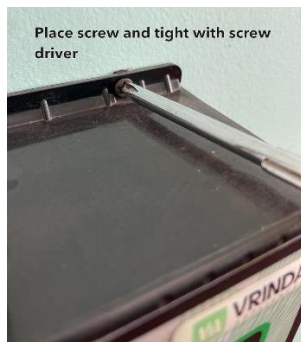

5. Fix the antenna gently, do not overtight.
6. Plug the motor module power to the plug point with proper tightening of the L, N and E wires.
7. Plug the motor wire to the device plug point.

If Module for sump tank supplied, follow the wiring instructions pasted on the module itself. Fix the Module against the wall with the help of two screws.

3. Operational Procedures

3.1 Daily Use

- Turn on the appliance using the main power switch.
- Select the desired settings based on your needs.
- Start the operation and monitor the appliance during its use.

3.2 Cleaning

- Turn off and unplug the appliance before cleaning.
- Use a soft cloth to clean the exterior surfaces

3.3 Maintenance

- Regularly inspect the appliance for wear and tear.

For operation procedure, follow the instructions pasted and mentioned on the device.